xtension.

The lighter and easier to set up fabric pop-up

xtension. the all new, ultra quick to set-up pop-up display



This portable display features a fabric graphic that remains attached to the structure and unfolds to widths of up to 5 m (16.4 ft.)



5 great reasons to choose **xtension**.

- 1. Fast and easy to set up:** Its system of magnetic connectors and a graphic that attaches with hook-and-loop fasteners allow you to set up and dismantle the structure in less than 30 seconds.
- 2. Aesthetically-pleasing:** Offers a large, seamless image with a tight and wrinkle-free graphic.
- 3. Practical:** The graphic remains attached to the structure, which allows for very easy and compact storage.
- 4. Lightweight and compact:** The aluminum structure and printed graphics make the solution lightweight and easy to transport (weighs less than 5Kg - 11 lbs, excluding the carrying case).
- 5. Durable and Versatile:** The solution is easily adaptable to your ever-changing communication needs. The graphics are easily interchangeable and the structure comes with a lifetime guarantee against manufacturer's defects.

Choose the **xtension.** best suited to your needs

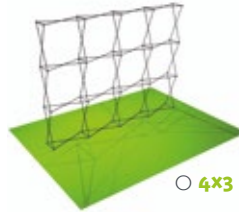

Four standard configurations

xtension.1x3 L 770 mm x H 2240 mm x P 340 mm (89" x 31" x 13.39")

xtension.2x3 L 1510 mm x H 2240 mm x P 340 mm (89" x 59" x 13.39")

xtension.3x3 L 2240 mm x H 2240 mm x P 340 mm (89" x 89" x 13.39")

xtension.4x3 L 2970 mm x H 2240 mm x P 340 mm (89" x 118" x 13.39")

For customized configurations up to 5 m (16.4 ft.), please contact us for more information

When to use the **xtension**.?



xtension. is the ideal solution for events, store and shopping mall events, field sales people, trade shows and conventions.

The difference is in the details

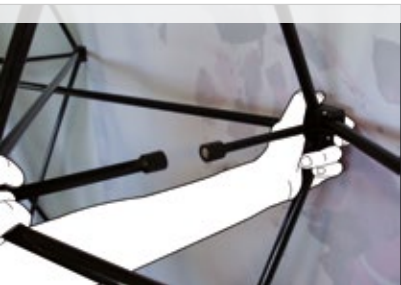

>Aluminum structure



>Magnetic connectors



>hook-and-loop fasteners



>LED display lights

The lighter and easier to set up pop-up



Comparison between the **xtension.** and a conventional pop-up display with magnetic bars and encapsulated paper graphics.

SEE THE DIFFERENCE:	xtension.3x3	CONVENTIONAL POP-UP STAND
WEIGHT (with carrying case solution)	8,2 kg - 18.08 lbs	30 Kg - 60 lbs
NUMBER OF PARTS	1 (structure & attached graphic)	12 (1 structure + 6 magnetic bars + 5 graphics)
INTERCHANGEABLE GRAPHIC	YES	YES
SET UP TIME	30 seconds (pre-installed graphic)	16 minutes
TRANSPORT COSTS (Example: Chicago to NYC by FedEx)	40€ - \$31	96€ - \$51
TRANSPORT	Ultra Portable (Train, subway, etc...)	Portable (car...)
LONGEVITY	Excellent as it is less fragile (fabric graphic)	Average (encapsulated paper)
ECO-FRIENDLY	No lamination used, Imprim'vert-certified printing, aqueous ink base (98% water), graphics recyclable at end of life. Consumes less CO2 during transport	75% more energy consumed in addition to the fabric for the entire life cycle (EVA audit-consulting) Laminated graphics

xtension. shipping solutions

L Hard case
on wheels

M Hard case
on wheels



A wide range of available cases specially adapted to your needs protect your **xtension**.
Choose between durable, reinforced soft-sided bags or hard waterproof cases.

Case-to-counter conversion

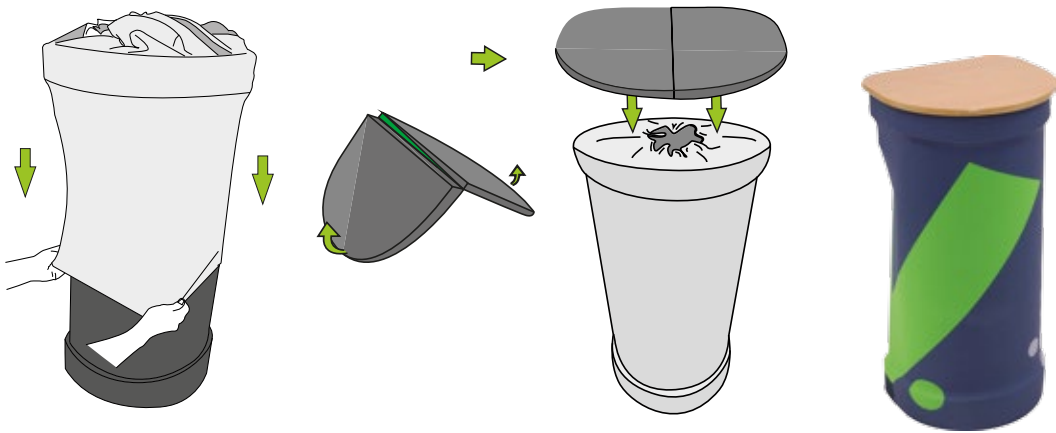

2 in 1 Counter

With a wood counter top, transport bag and printed graphic wrap,
your container transforms into a real counter.

xtension. Technical specifications

	xtension.1x3	xtension.2x3	xtension.3x3	xtension.4x3
Set-up	less than 30 seconds			
Height	Adjustable height / Standard height 2250 mm - 89"			
Width	770 mm - 31"	1510 mm - 59"	2240 mm - 89"	2970 mm - 118"
Total weight hardware + graphic	2,4 Kg - 8.4lbs	4,9 Kg - 12.8lbs	7 Kg - 18.3lbs	9,7 Kg - 20lbs
Materials	Frame: Aluminum and plastic injection Graphic: polyester with water-based dyes (no solvent).			
Transport solutions	Hard case M : 5,4 kg - 11.9 lbs ou transport bag (TRB013) : 1,1 kg -2.43 lbs	Hard case M : 5,4 kg - 11.9 lbs ou transport bag (TRB013) : 1,1 kg -2.43 lbs	Hard case M : 5,4 kg - 11.9 lbs ou transport bag (TRB013) : 1,1 kg -2.43 lbs	Hard case L : 9,3 kg -20.5 lbs ou transport case on wheels (TRB015) : 4,1 kg

Scan me to get set-up instructions

